

Skydio 2+ Enterprise



Breakthrough Intelligence. Impossible Video.

Skydio 2+ (S2+) is the industry-leading autonomous drone solution, powered by Skydio Autonomy Enterprise, an AI-driven autonomous flight engine that enables unparalleled 360° obstacle avoidance, autonomous tracking, GPS-denied navigation, and complete workflow automation. Equipped with NVIDIA Tegra TX2 with 256 GPU cores, S2+ brings industry-leading compute power to the edge of your infrastructure, automating data collection for situational awareness, inspection or security. Designed, assembled, and supported in the USA, S2+ provides a higher degree of supply chain security.

Optional Add-ons

- ⊕ **Skydio Beacon™.** A first-of-its-kind drone controller for GPS drone tracking. Beacon makes it easy to follow fast moving subjects such as people or dogs.
- ⊕ **Skydio 3D Scan™.** Adaptive scanning to automate the image capture process to document complex structures and generate 3D models with comprehensive coverage and ultra-high resolution. Perform higher quality inspections and documentation faster and with minimal pilot training.
- ⊕ **Skydio Cloud™.** Enables federated fleet management and seamless upload of flight media. No more manual handling of SD cards and hard drives.



MAX RANGE

6.0
km*

CAMERA

4K60
HDR / 12.3
MP

FLIGHT TIME

27
min

*Always follow local rules, regulations, and FAA guidelines, and fly your drone in line of sight at all times.

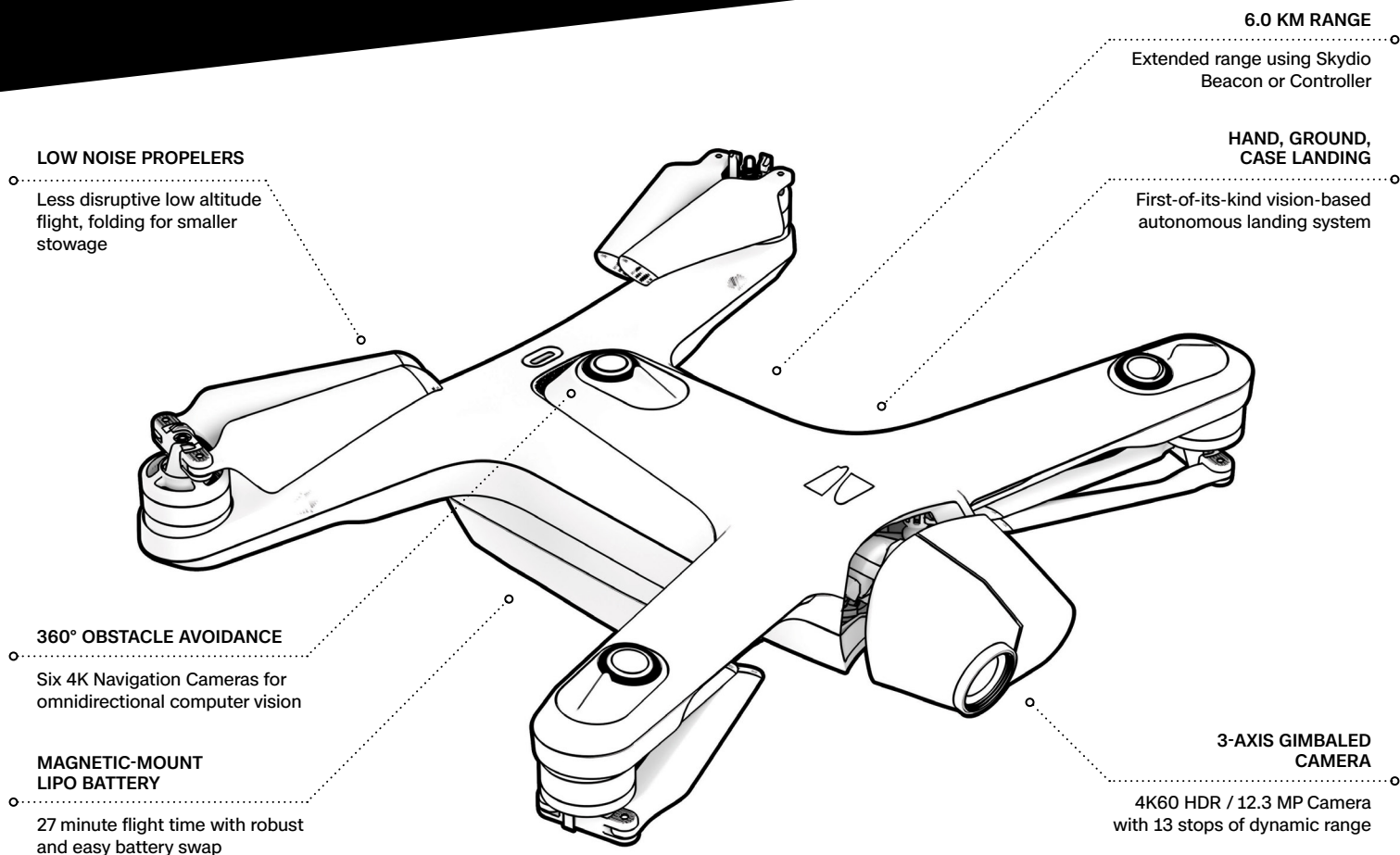

AIRCRAFT	
DIMENSIONS WITH BATTERY (ANTENNAS UP)	229 x 274 x 126 mm
WEIGHT (WITH BATTERY)	800 g
FLIGHT TIME	Up to 27 minutes
MAX FLIGHT SPEED (SEA LEVEL, NO WIND)	36 mph
MAX WIND SPEED RESISTANCE	25 mph
MAX SERVICE CEILING (ABOVE SEA LEVEL)	Up to 15,000 ft
OPERATIONAL TEMPERATURE RANGE	-5°C to 40°C

SKYDIO AUTONOMY ENTERPRISE	
MAIN PROCESSOR	NVIDIA Tegra X2 SOC
ENVIRONMENT COVERAGE	True 360°
3D WORLD MODEL UPDATE RATE	> 1 million points per secon
USER-SELECTABLE SUBJECTS FOR TRACKING	People and motor vehicles
ONBOARD AI	9 deep networks used in flight
ADVANCED AI-PILOT ASSISTANCE	360 Superzoom, Close Proximity, Obstacle Avoidance, Scout, TAK integration, Point-of-Interest Orbit, Track-in-Place, Vertical View, Visual Return-to-Home

PRIMARY CAMERA SYSTEM	
COLOR SENSOR TYPE	12.3 MP CMOS
COLOR LENS FOCAL LENGTH	20mm (35mm format equivalent)
COLOR VIDEO RESOLUTION	4K / 60 fps with 16x digital zoom
COLOR DYNAMIC RANGE	13 stops
PITCH CONTROLLABLE RANGE	-110° to +90°



Contact enterprise@skydio.com today to learn more about integrating Skydio 2+.
Designed and assembled in the USA